

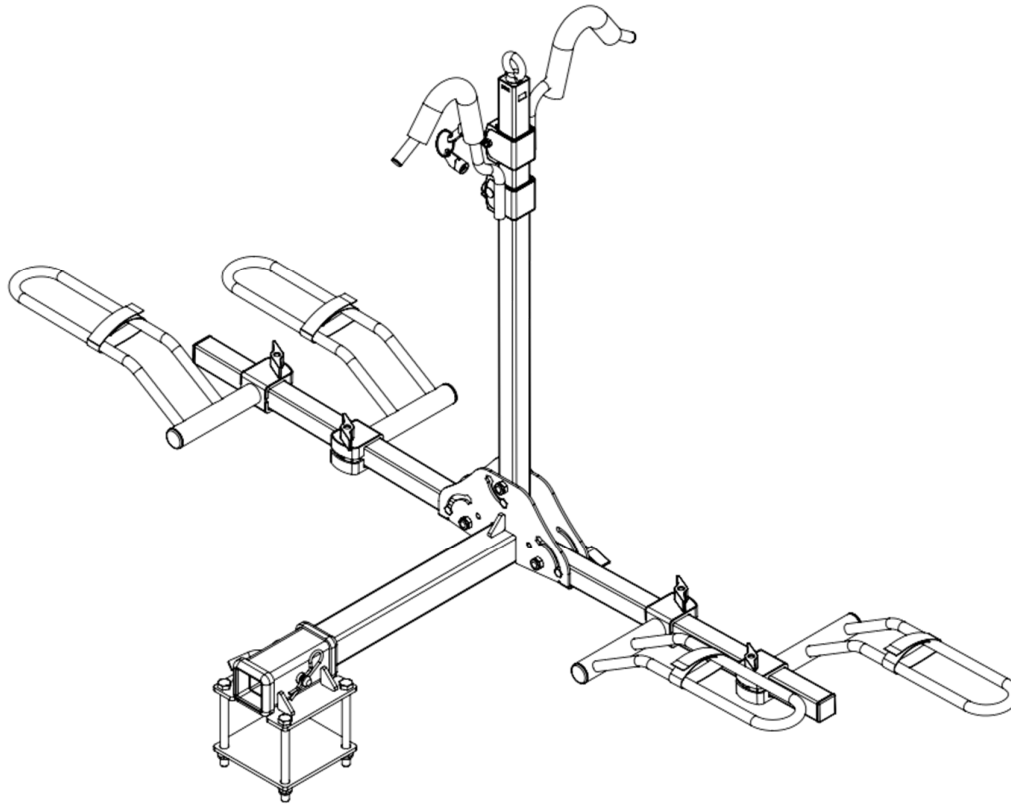

**STROMBERG CARLSON
PRODUCTS INC.**

Platform-Style 2-Bike Rack for 2" Hitches or RV Bumpers

Model BC-202BA



MAXIMUM LOADING CAPACITY - 80 LBS

Recommended Tools for Assembly:



Open Wrench
(1pcs)
Size=17mm



Open Wrench
(2pcs)
Size=19mm

Stromberg Carlson Products, Inc.
2323 Traversefield Drive
Traverse City, Michigan 49686
231-947-8600 ext. 108 for Customer Service
info@strombergcarlson.com





**STROMBERG CARLSON
PRODUCTS INC.**

2" Hitch Operating Instructions

STEP 1 Assemble the primary frame by connecting the Support Base Assembly (part #1) and (2) Horizontal Tubes (part #2) using (2) 5/16" knob, (4) 5/16" flat washer, (2) 5/16" spring washer, (2) 5/16" hexagon bolt, (2) M10 Carriage bolts and (2) M10 Locknuts (parts #3, #4, #5, #6, #22 & #23). See FIG. 1

FIG.1

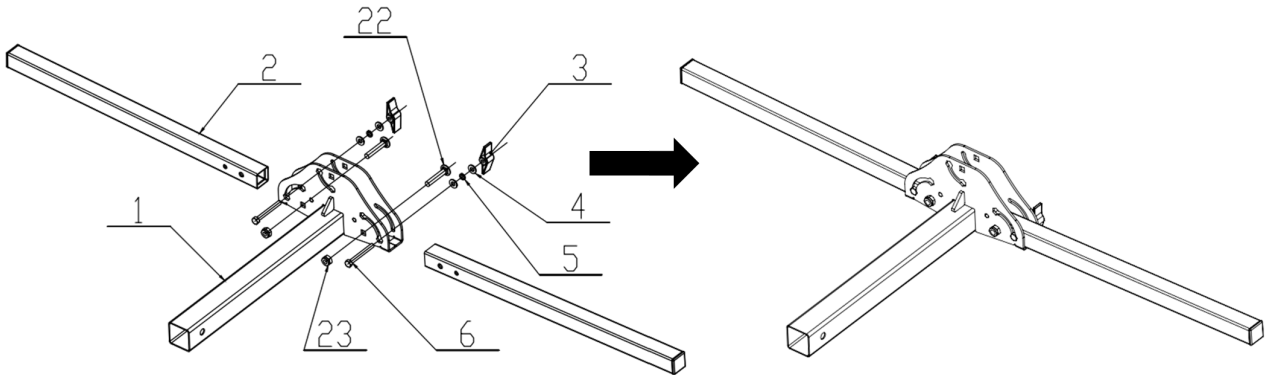

STEP 2 Place Vertical Tube (part #7) into the Support Base Assembly by using M10 Carriage Bolt and M10 Locknut (parts #22 & #23). With the Vertical Tube in a vertical position, insert the 5/16" hexagon bolt (part #6), through the 5/16" flat washer (part #4), the 5/16" spring washer (part #5) and the 5/16" flat washer (part #4), tighten with 5/16" knob (part #3). See FIG. 2

FIG. 2

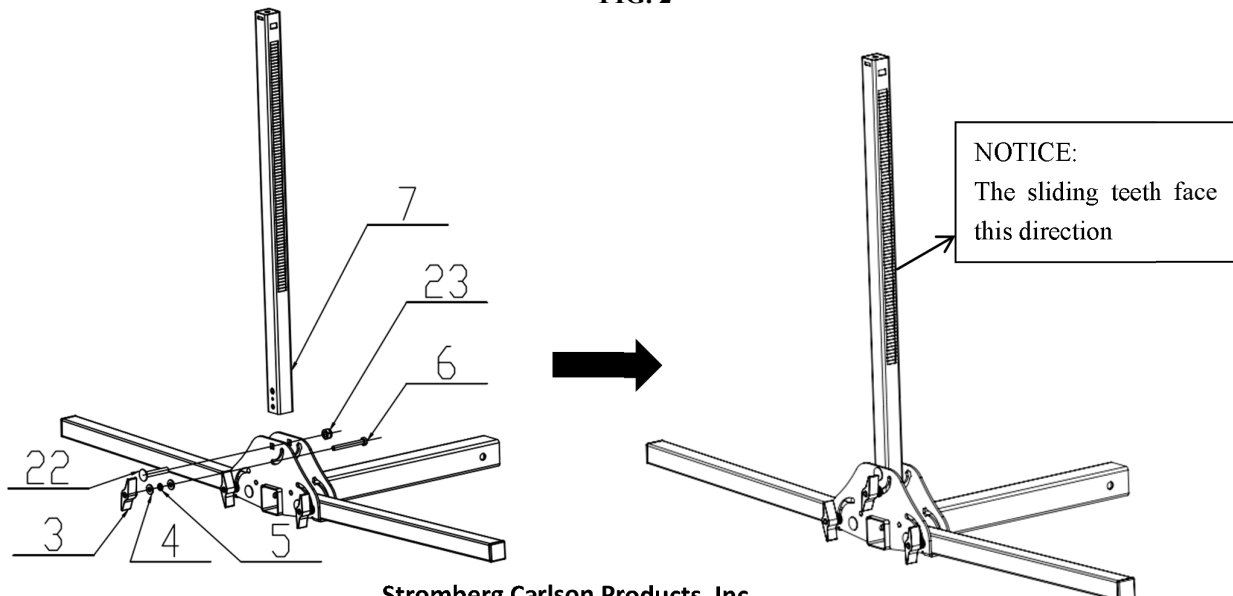

Stromberg Carlson Products, Inc.
2323 Traversefield Drive
Traverse City, Michigan 49686
231-947-8600 ext. 108 for Customer Service
info@strombergcarlson.com





**STROMBERG CARLSON
PRODUCTS INC.**

STEP 3 Slide the Left and Right Cradle Assemblies (parts #8 & #9) onto the Horizontal Tubes. Release the knob of the left and right cradle. The knob should be facing up and the loop end of cradle should be facing outward and upward. Insert the cradles in sequence as shown below in FIG. 3. Once all 4 cradles are on the Horizontal Tubes, tighten. See FIG. 3

FIG. 3

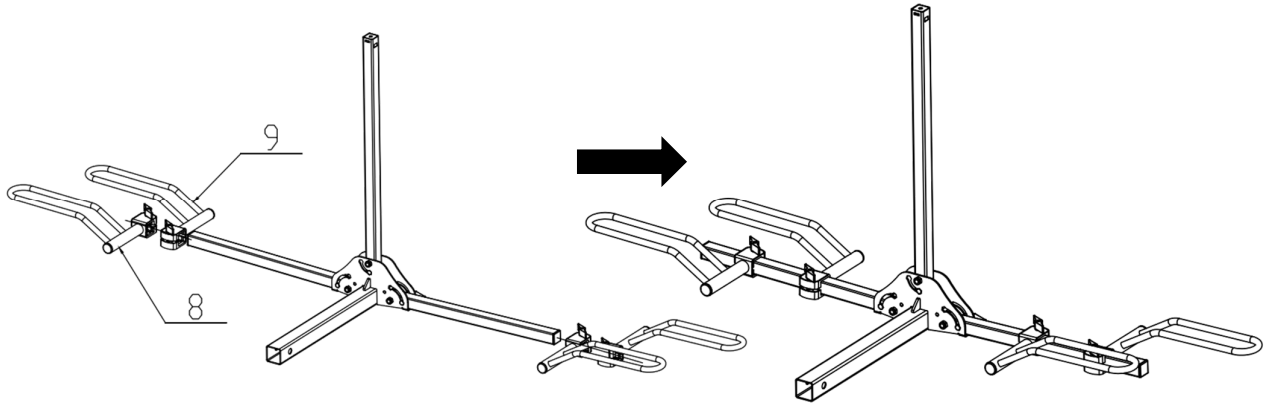

STEP 4 Install the Long J-Hook Assembly (part #10) and Short J-Hook Assembly (part #11) onto the Vertical Tube, then tighten the M10 Eyebolt (part #12). Put the Reflector (part #13) in the hole of the square tube. See FIG. 4

NOTE: Eyebolt provided for use with customer-provided bike cable and lock, to prevent bicycle loss.

FIG. 4

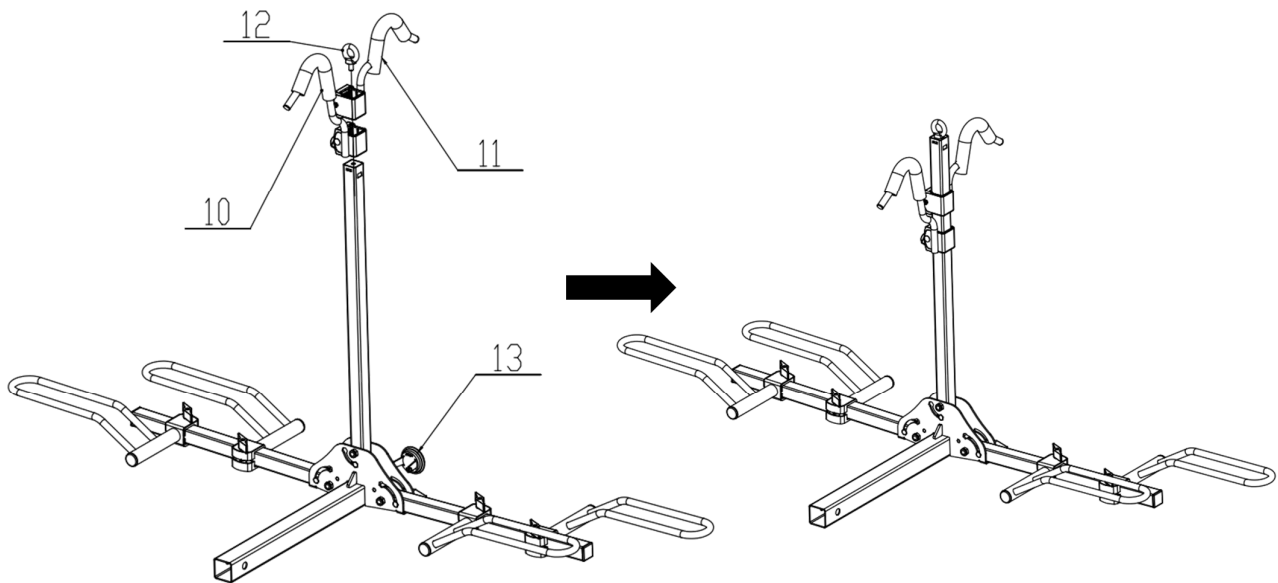

Stromberg Carlson Products, Inc.
2323 Traversefield Drive
Traverse City, Michigan 49686
231-947-8600 ext. 108 for Customer Service
info@strombergcarlson.com





**STROMBERG CARLSON
PRODUCTS INC.**

RV Bumper Operating Instructions

If you are mounting the rack onto a 4" - 4.5" RV bumper rather than into your 2" receiver, you will need to use the Bumper Adapter. It can only be mounted on a continuous steel welded RV bumper. If you are not sure if this is the type of bumper you have please contact your RV dealer.

Position the Bumper Adapter (part #14) on to the top of the 4" - 4.5" square bumper. Position the Plate (part #16) on the underside and attach using (4) M12x140 Hexagon Bolts and (4) M12 Locknuts (parts #15 & #17). Tighten the bolts securely. Insert Support Base Assembly into Bumper Adapter, use (1) Hitch Pin, (1) Clip and (1) M10x20 Hexagon Bolt (parts #18, #19 & #20) to attach. See FIG 5.

FIG. 5

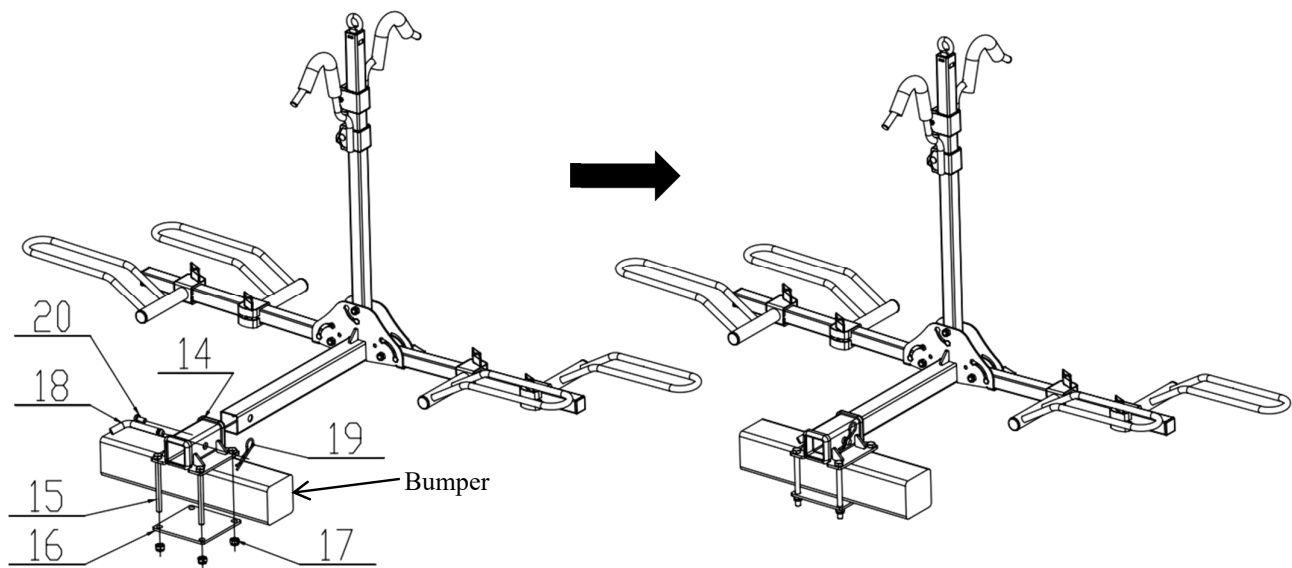

Mounting Bikes

The wheel cradles and J-Hooks are completely adjustable and slide on the tubes.

1. Load inner bicycle first. Loosen the 5/16" knob and expose the head of the 5/16" hexagon bolt outside the support base assembly, then rotate vertical tube down. See FIG. 6
2. Load bicycle into Wheel Cradles. Adjust cradles to appropriate position. Ensure tire is well supported at both ends of Wheel Cradles. Tighten cradles to prevent movement. See FIG. 7
3. Rotate vertical tube to vertical position and lock with the 5/16" knob. Lower J- Hook Assembly down over bicycle frame. See FIG. 8
4. Apply downward pressure to bicycle and J-Hook Assembly. Tighten J-Hook Assembly and ensure there is no movement of bicycle.

Stromberg Carlson Products, Inc.
2323 Traversefield Drive
Traverse City, Michigan 49686
231-947-8600 ext. 108 for Customer Service
info@strombergcarlson.com





**STROMBERG CARLSON
PRODUCTS INC.**

FIG. 6

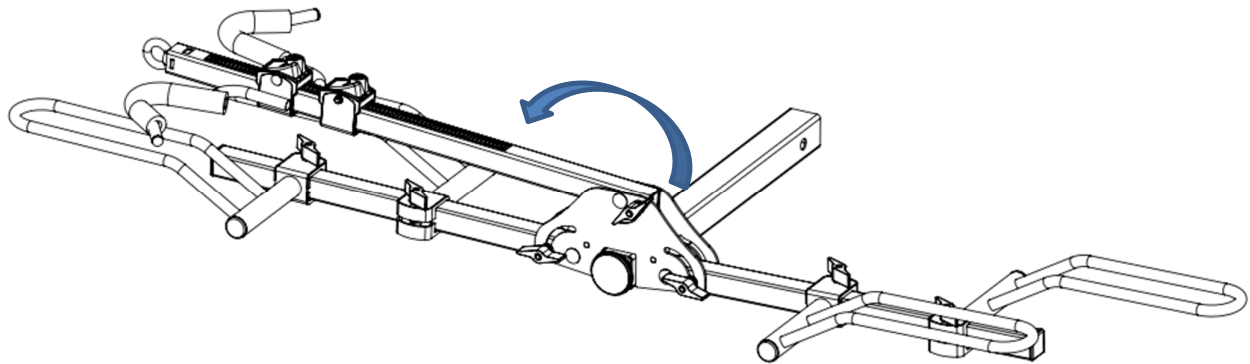
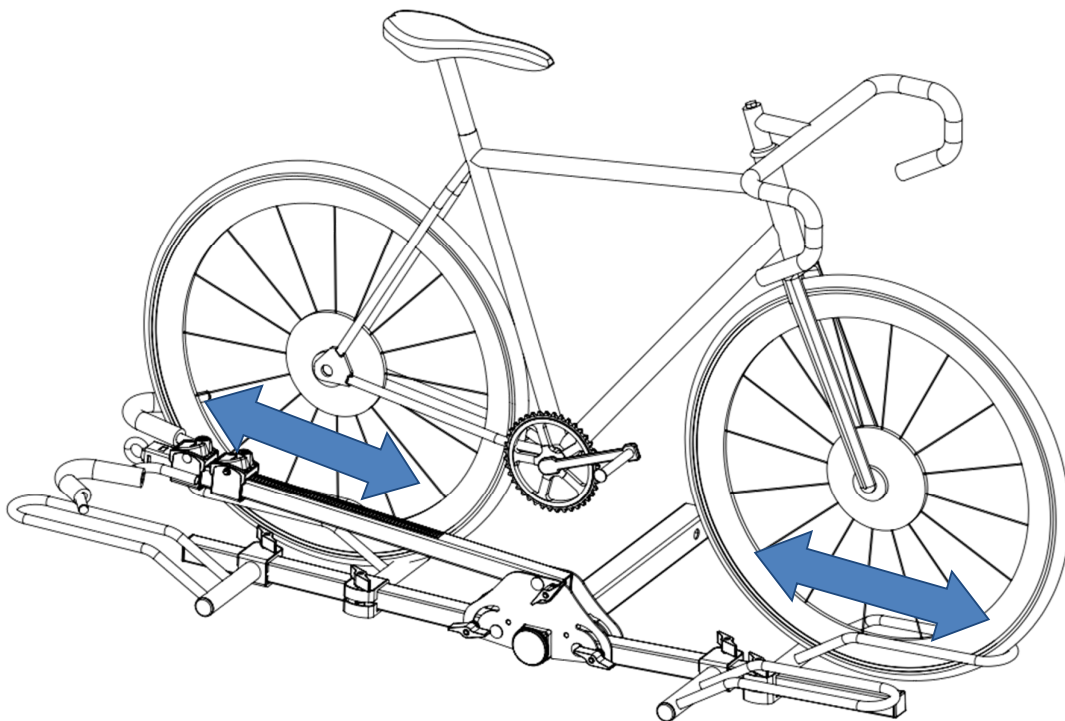

FIG. 7



Stromberg Carlson Products, Inc.
2323 Traversefield Drive
Traverse City, Michigan 49686
231-947-8600 ext. 108 for Customer Service
info@strombergcarlson.com





**STROMBERG CARLSON
PRODUCTS INC.**

FIG. 8

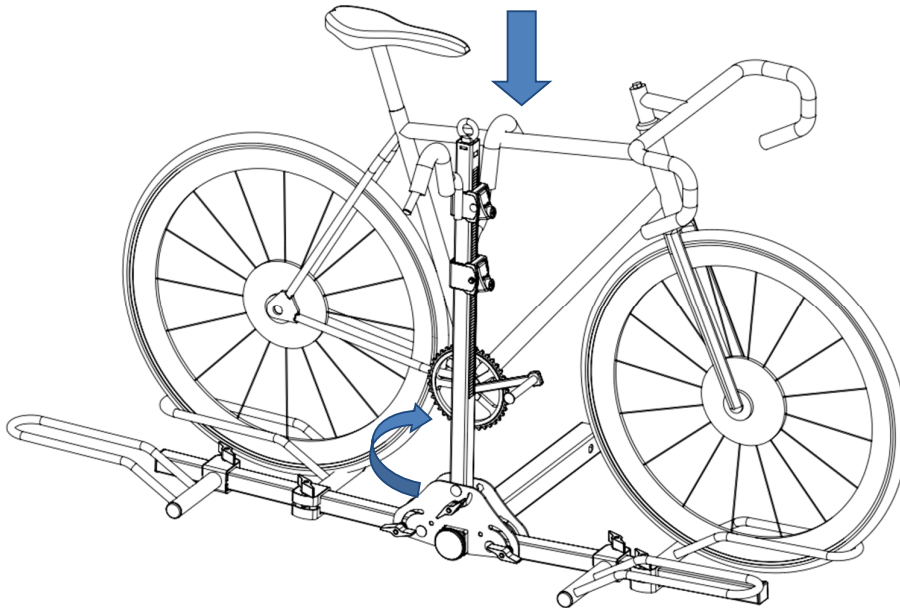

5. Loop (1) Wheel Cradle Strap (part #22) over each wheel and secure. See FIG. 9

WARNING – Failure to use wheel cradle straps may result in bike falling off rack during use.

6. Load second bicycle as described in Bicycle Mounting steps 2 thru 5. Reverse direction of second bicycle to prevent handle bar interference. See FIG. 10

FIG. 9

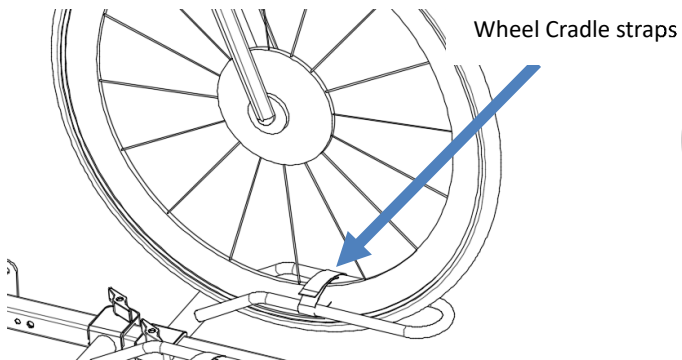
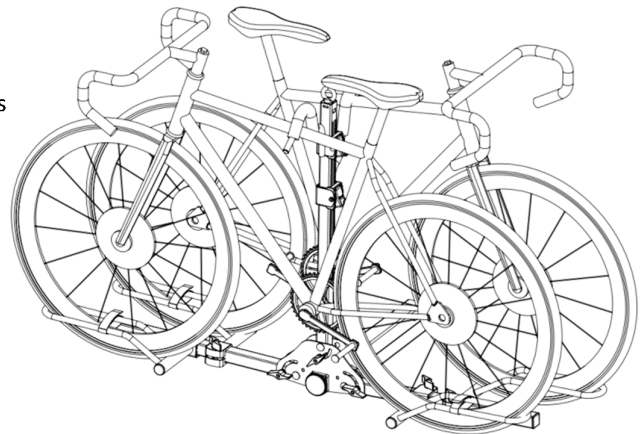

FIG. 10



Stromberg Carlson Products, Inc.
2323 Traversefield Drive
Traverse City, Michigan 49686
231-947-8600 ext. 108 for Customer Service
info@strombergcarlson.com





**STROMBERG CARLSON
PRODUCTS INC.**

Storage Feature

Loosen the 5/16" knob, rotate the support tube to the vertical states, and then tighten the 5/16" knob. See FIG. 11

FIG. 11

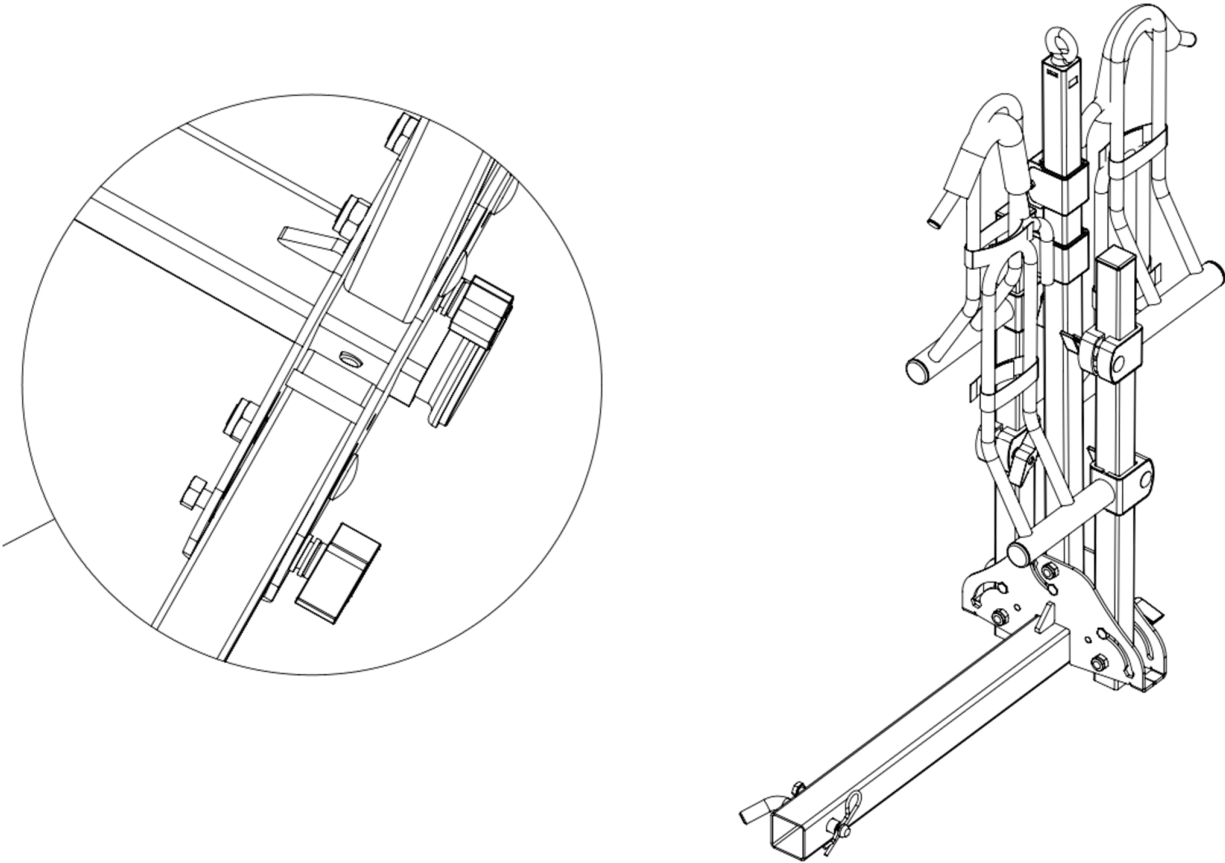

Stromberg Carlson Products, Inc.
2323 Traversefield Drive
Traverse City, Michigan 49686
231-947-8600 ext. 108 for Customer Service
info@strombergcarlson.com



Assembly Diagram

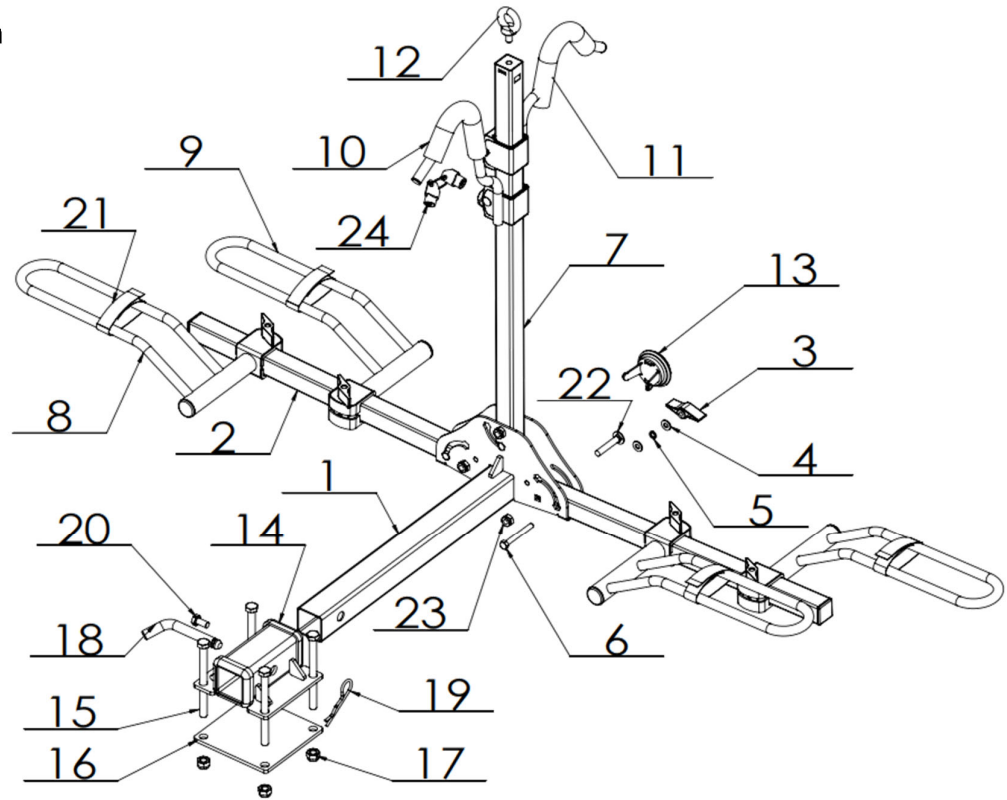

Carton Contents

Part#	Description	Qty	Part#	Description	Qty
1	Support Base Assembly	1	13	Reflector	1
2	Horizontal Tube	2	14	Bumper Adapter	1
3	5/16" Knob	3	15	M12x140 Hexagon Bolt	4
4	5/16" Flat Washer	6	16	Plate	1
5	5/16" Spring Washer	3	17	M12 Locknut	4
6	5/16" Hexagon Bolt	3	18	Hitch Pin	1
7	Vertical Tube	1	19	Clip	1
8	Left Cradle Assembly	2	20	M10-20 Hexagon Bolt	1
9	Right Cradle Assembly	2	21	Wheel Cradle Strap	4
10	Long J-Hook Assembly	1	22	M10 Carriage Bolt	3
11	Short J-Hook Assembly	1	23	M10 Locknut	3
12	M10 Eyebolt	1	24	Circular Key	1

Stromberg Carlson Products, Inc.
2323 Traversefield Drive
Traverse City, Michigan 49686
231-947-8600 ext. 108 for Customer Service
info@strombergcarlson.com

